

C300 Grade 2 cylindrical locksets

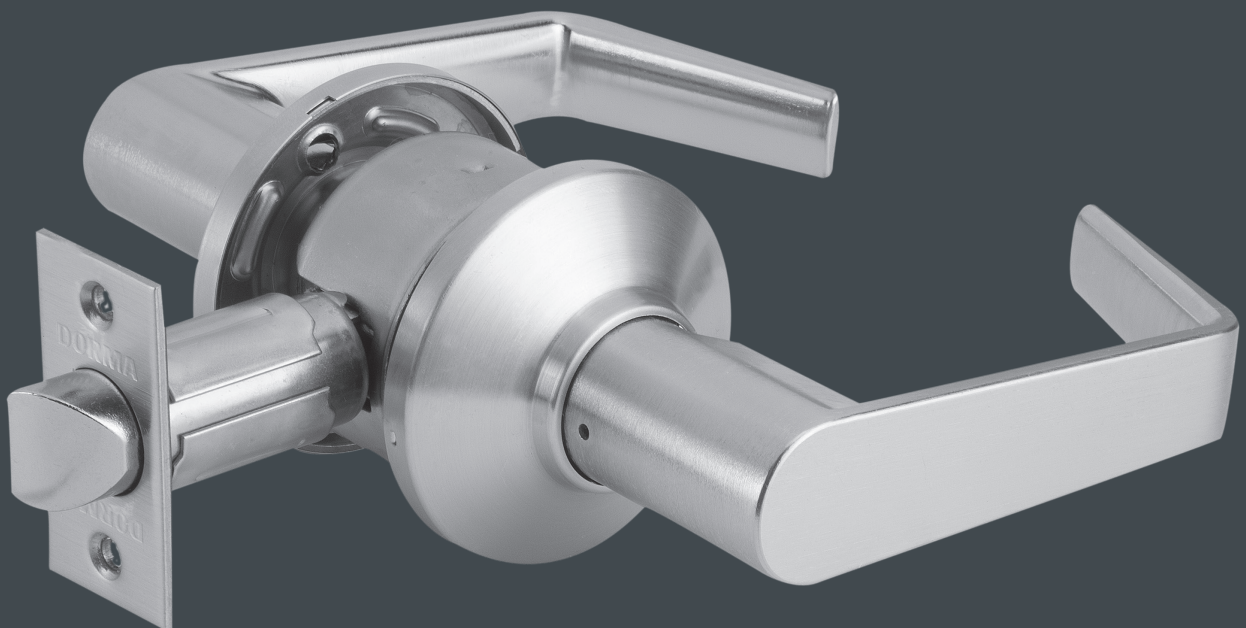

C300 Series Grade 2 cylindrical locksets

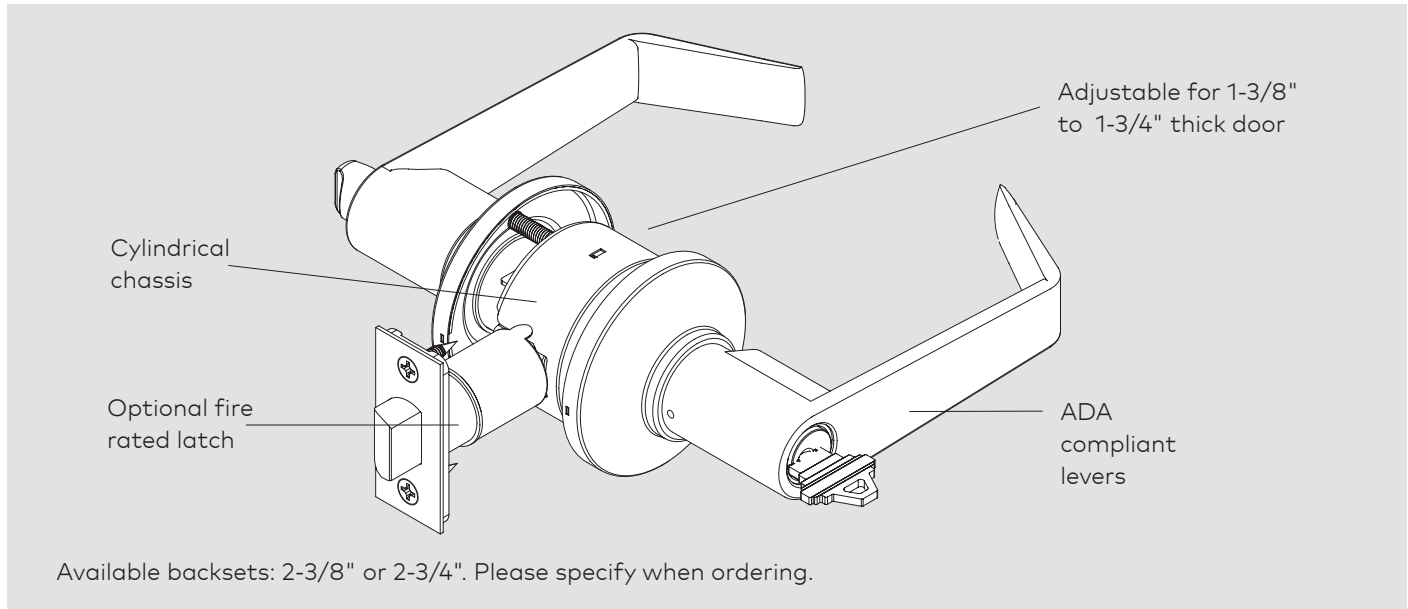

The C300 is an economy ANSI/BHMA certified Grade 2 cylindrical lever lockset geared for light-duty, price sensitive commercial applications.

The C300 features a 2-1/2" diameter rose and is suited for multifamily apartment units, condominiums, hotels, assisted living, and other commercial facilities of a light duty type.

Features

- Concealed fasteners on rose.
- Door thickness range from 1-3/8"–1-3/4".
- 1/2" throw latch.
- 2-1/2" diameter rose.
- Non-handed for easy installation (LS lever is handed).

Certification

- ANSI/BHMA A156.2 Grade 2 certified.

- Optional UL listed 3 hour fire rated.
- Meets A117.1 accessibility code and ADA requirements for barrier-free accessibility.



Finishes

- 605 (Bright Brass)
- 613 (Dark Bronze)
- 619 (Satin Nickel)
- 626 (Satin Chrome)

Lever styles

- LR, LC, LG, LS

Recommended applications

- Apartments
- Assisted living
- Condominiums
- Other multifamily housing

Warranty

For details, refer to **Limited Warranty** on our website at go.dormakaba.com/terms-DA

DORMA USA quality and environmental management systems in Reamstown, PA and Steeleville, IL are certified to ISO 9001:2008 and ISO 14001:2004.



How to order C300 Series locksets

Product family Grade 2 cylindrical lockset	Lever (handed) —	LSB	2-3/8" fire —	238F	Strike ANSI strike, square corner — 5001 T strike, square corner — 5101 Full lip, square corner — 5201 Full lip, radius corner — 5202	Cylinder type D — Standard cylinder	Keying				
	Lever —	LGB	2-3/4" fire —	234F							
	Lever —	LCB	2-3/8" non-fire* —	238N							
	Lever —	LRB	2-3/4" non-fire* —	234N							
		C3	53	LRB	626	234F	100R	5202	RH	D	SCKD
Single dummy —	01			626 — Satin chrome	100S — 1" square	RH	SC — SC keyway				
Passage —	10			613 — Dark bronze	118S — 1-1/8" square	LH	D100 — DORMA SKC D100 keyway				
Patio —	30			619 — Satin nickle	100R — 1" radiused	Handing		Keyway			
Privacy —	40			605 — Bright brass	DRIV — Drive-in						
Entry —	53			Finish	Faceplate						

* C353 and C330 only available with fire rated latch.

Finish availability chart

	626	613	619	605
LR	•	•		
LC	•	•		•
LG	•	•	•	
LS		•	•	•

Trim options

Lever designs

LC lever



LG lever



LR lever





L118 lever

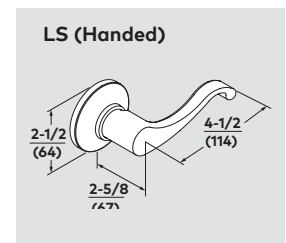
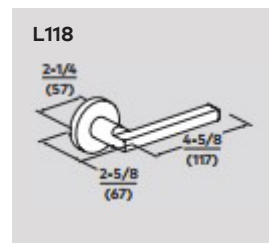
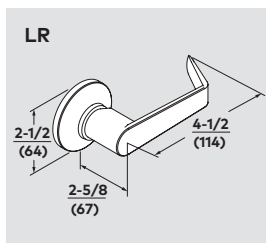
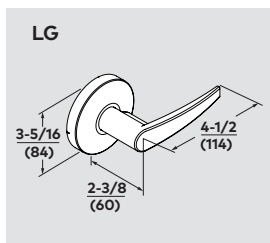
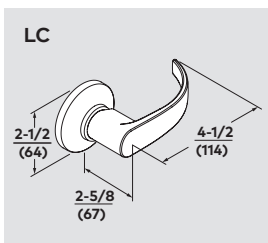

LS lever

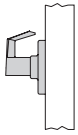

Functions

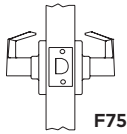
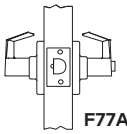
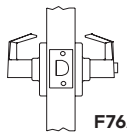
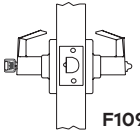
Function	Series	Outside/Inside	Description
Dummy trim one side	C301		<ul style="list-style-type: none"> Used as pull or matching trim on pairs of doors.  Indicates rigid lever
Passage/closet	C310	 F75	<ul style="list-style-type: none"> Latch bolt operated by trim either side at all times.
Patio Only available with fire rated latch	C330	 F77A	<ul style="list-style-type: none"> Deadlocking latch bolt operated by trim either side. Outside trim locked by push button inside. Outside trim unlocked by trim inside. Outside trim unlocked by closing door. Inside trim always unlocked. Do not use in rooms that have no other entrance.
Privacy, bedroom, or bath	C340	 F76A	<ul style="list-style-type: none"> Latch bolt operated by trim either side. Outside trim locked by push button inside. Outside trim unlocked by emergency release outside. Outside trim unlocked by trim inside. Outside trim unlocked by closing door. Inside trim always unlocked.
Entry Only available with fire rated latch	C353	 F109	<ul style="list-style-type: none"> Deadlocking latch bolt operated by trim either side, except when outside trim locked by push button inside. Key outside releases push button, unlocking outside trim, except when inside button pushed and turned to keep outside trim locked. Operating inside trim releases push button, unlocking outside trim, except when inside button pushed and turned to keep outside trim locked. Inside button must be turned to unlock outside trim. Inside trim always operates latch bolt.

Lock options

Strikes

ANSI strike - 5001

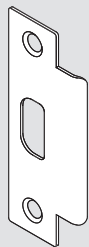

T strike - 5101

Full lip - 5201 (square corner)
or 5202 (radius corner)